

SPECIFICATIONS & DIMENSIONS

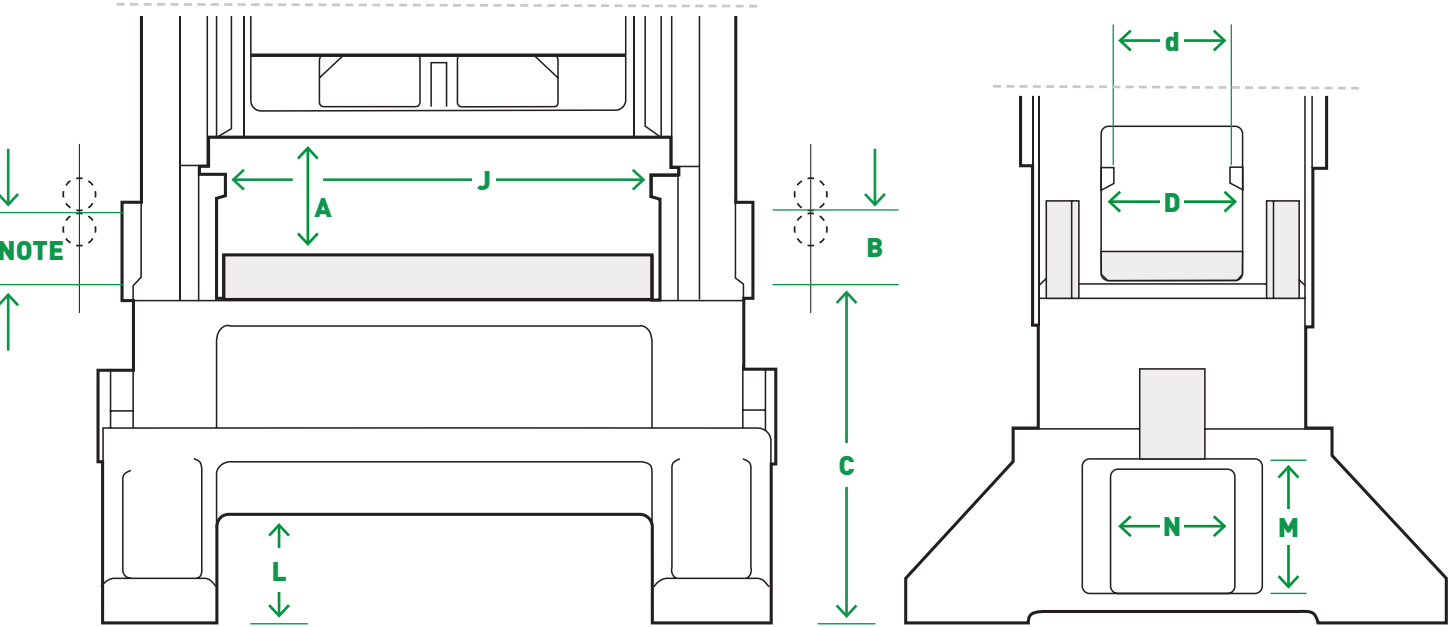

NOTE: Specify maximum and minimum feed line height from bed.

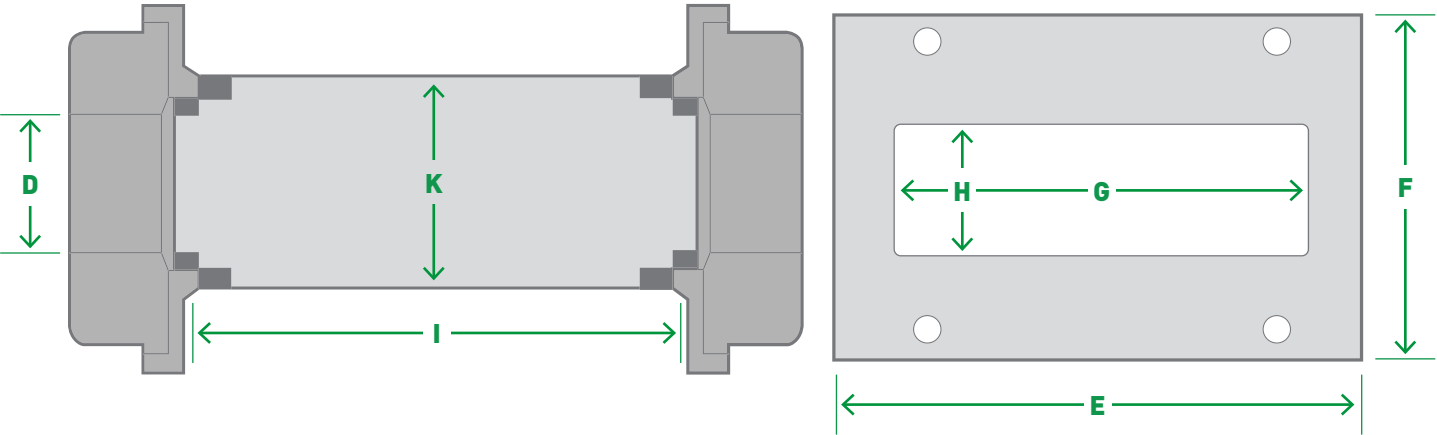

	P2-60	P2-100		P2-150		P2-200	
Dimensions Common to all Widths	Flywheel Type	Flywheel Type	Single Geared	Flywheel Type	Single Geared	Flywheel Type	Single Geared
Tons Capacity at Bottom of Stroke	550 kN	910 kN		1350 kN		1800 kN	
Crankshaft Dia. @ Bearings/Min. Dia. of Eccentrics	100/145	125/170		165/235		180/235	
Crankshaft Extension (Standard): Length/Diameter	165/85	255/100		255/125		225/125	
Crankshaft Extension (Standard): Keyway Size	20 x 10	20 x 10		30 x 15		30 x 15	
Adjustment of Slide: Standard Locking Arrangement	75	100		100		150	
A Shutheight on Bolster, S.D.A.U. (Standard Stroke 25 mm)	320	370		470		495	
A Shutheight on Bolster, S.D.A.U. (Standard Stroke 50 mm)	305	405		455		480	
A Shutheight on Bolster, S.D.A.U. (Standard Stroke 75 mm)	290	395		420		445	
A Shutheight on Bolster, S.D.A.U. (Standard Stroke 100 mm)	280	380		405	475	510	
A Shutheight on Bolster, S.D.A.U. (Standard Stroke 125 mm)		355		375	445	495	
A Shutheight on Bolster, S.D.A.U. (Standard Stroke 150 mm)			380		430	480	
A Shutheight on Bolster, S.D.A.U. (Standard Stroke 175 mm)							420
A Shutheight on Bolster, S.D.A.U. (Standard Stroke 200 mm)							405
B Thickness of Bolster Plate	90	125		150		175	
C Distance Floor to Top of Bed	865	915		1065		1065	
d/D Opening in Upright (Absolute Maximum) F-B	265/305	355/405		380/455		380/510	
M&N Opening in Leg (Exit Side) T-B x F-B	355 x 315	355 x 355		380 x 455		380 x 510	
Overall Height (Approximate)	2870	3405		3990		4115	
kW and Speed of Variable Speed Motor Drives	11.25/1800	15/1800		18/1200 or 18/1800		22/1200 or 22/1800	
Sliding Die Cushion -- Capacity	23 kN	87 kN		139 kN		139 kN	
Width of Press				1220		1525	
I&K Area of Slide: R-L x F-B				1220 x 585		1525 x 760	
J Distance Between Gibs				1,270		1575	
E&F Area of Bolster and Bed: R-L x F-B				1220 x 1015		1525 x 1115	
G&H Opening in Bed: R-L x F-B				965 x 480		1370 x 445	
L Floor to Bottom of Bed to Clear (Without Mounts)				355		305	
Floor Space Overall: R-L x F-B				2820 x 2335	2715 x 2310	3175 x 2390	3075 x 2465
Weight (kg)				21,150	22,950	30,150	32,400
Width of Press	1220	1220		1525		1830	
I&K Area of Slide: R-L x F-B	1220 x 380	1220 x 470		1525 x 585		1830 x 760	
J Distance Between Gibs	1270	1270		1575		1880	
E&F Area of Bolster and Bed: R-L x F-B	1220 x 635	1220 x 785		1525 x 1015		1830 x 1115	
G&H Opening in Bed: R-L x F-B	1065 x 230	1040 x 380		1270 x 455		1525 x 455	
L Floor to Bottom of Bed to Clear (Without Mounts)	340	305		355		305	
Floor Space Overall: R-L x F-B	2185 x 1370	2665 x 1525	2490 x 1830	3125 x 2335	3020 x 2310	3480 x 2385	3380 x 2465
Weight (kg)	8,910	12,690	13,770	23,400	25,650	30,600	32,400
Width of Press		1525					
I&K Area of Slide: R-L x F-B		1525 x 470					
J Distance Between Gibs		1575					
E&F Area of Bolster and Bed: R-L x F-B		1525 x 470					
G&H Opening in Bed: R-L x F-B		1345 x 380					
L Floor to Bottom of Bed to Clear (Without Mounts)		305					
Floor Space Overall: R-L x F-B		2970 x 1525	2795 x1830				
Weight (kg)		13,950	14,940				

SPECIFICATIONS & DIMENSIONS

U.S. STANDARD		P2-60		P2-100		P2-150		P2-200	
Dimensions Common to all Widths		Flywheel Type	Flywheel Type	Single Geared	Flywheel Type	Single Geared	Flywheel Type	Single Geared	Flywheel Type
Tons Capacity at Bottom of Stroke (U.S. Tons)		60		100		150		200	
Crankshaft Dia. @ Bearings/Min. Dia. of Eccentrics		4/5.75		5/6.75		6.5/9.25		7/9.25	
Crankshaft Extension (Standard): Length/Diameter		6/3.375		10/3.875		10/5.0		10/5.0	
Crankshaft Extension (Standard): Keyway Size		.75 x .375		.75 x .375		1.25 x .62		1.25 x .62	
Adjustment of Slide: Standard Locking Arrangement		3.0		4.0		4.0		6.0	
A	Shutheight on Bolster, S.D.A.U. (Standard Stroke 1.0")	12.5	14.5		18.5		19.5		
A	Shutheight on Bolster, S.D.A.U. (Standard Stroke 2.0")	12.0	16.0		18.0		19.0		
A	Shutheight on Bolster, S.D.A.U. (Standard Stroke 3.0")	11.5		15.5	16.5		17.5		
A	Shutheight on Bolster, S.D.A.U. (Standard Stroke 4.0")	11.0		15.0	16.0	18.75		20.0	
A	Shutheight on Bolster, S.D.A.U. (Standard Stroke 5.0")			14.0	14.75	17.5		19.5	
A	Shutheight on Bolster, S.D.A.U. (Standard Stroke 6.0")			15.0		17.0		19.0	
A	Shutheight on Bolster, S.D.A.U. (Standard Stroke 7.0")							16.5	
A	Shutheight on Bolster, S.D.A.U. (Standard Stroke 8.0")							16.0	
B	Thickness of Bolster Plate	3.5		5.0		6.0		7.0	
C	Distance Floor to Top of Bed	34		36		42		42	
d/D	Opening in Upright (Absolute Maximum) F-B	10.5/12.0		14.5/16.0		19.0/20.0		21.0/22.0	
M&N	Opening in Leg (Exit Side) T-B x F-B	14 x 12.5		14 x 14		15 x 18		15 x 20	
	Overall Height (Approximate)	129		147		163		173	
	HP and Speed of Variable Speed Motor Drives	15/1,800		20/1,800		25/1,200 or 25/1,800		30/1,200 or 30/1,800	
	Sliding Die Cushion -- Capacity	2.5 Tons		9.6 Tons		15.3 Tons		15.3 Tons	
Width of Press						48		60	
I&K	Area of Slide: R-L x F-B					48 x 23		60 x 30	
J	Distance Between Gibs					50		62	
E&F	Area of Bolster and Bed: R-L x F-B					48 x 40		60 x 44	
G&H	Opening in Bed: R-L x F-B					38 x 19		54 x 18	
L	Floor to Bottom of Bed to Clear (Without Mounts)					14		12	
	Floor Space Overall: R-L x F-B				111 x 92	107 x 91	125 x 94	121 x 97	
	Weight (Lbs.)				47,000	51,000	67,000	72,000	
Width of Press		48		48		60		72	
I&K	Area of Slide: R-L x F-B	48 x 15		48 x 18.5		60 x 23		72 x 30	
J	Distance Between Gibs	50		50		62		74	
E&F	Area of Bolster and Bed: R-L x F-B	48 x 25		48 x 31		60 x 40		72 x 44	
G&H	Opening in Bed: R-L x F-B	42 x 9		41 x 15		50 x 19		60 x 18	
L	Floor to Bottom of Bed to Clear (Without Mounts)	13.5		12		14		12	
	Floor Space Overall: R-L x F-B	86 x 54	105 x 60	98 x 72	123 x 92	119 x 91	137 x 94	133 x 97	
	Weight (Lbs.)	19,800	28,200	30,600	52,000	57,000	68,000	72,000	
Width of Press				60					
I&K	Area of Slide: R-L x F-B			60 x 18.5					
J	Distance Between Gibs			62					
E&F	Area of Bolster and Bed: R-L x F-B			60 x 31					
G&H	Opening in Bed: R-L x F-B			53 x 15					
L	Floor to Bottom of Bed to Clear (Without Mounts)			12					
	Floor Space Overall: R-L x F-B		117 x 60	110 x 72					
	Weight (Lbs.)		31,000	33,200					

SPEED / STROKE COMBINATIONS

Stroke	P2-60 FLYWHEEL		P2-100 FLYWHEEL		P2-150 FLYWHEEL		P2-200 FLYWHEEL		P2-100 GEARED		P2-150 GEARED		P2-200 GEARED	
	Std. Speed	Max. Speed	Std. Speed	Max. Speed	Std. Speed	Max. Speed	Std. Speed	Max. Speed	Std. Speed	Max. Speed	Std. Speed	Max. Speed	Std. Speed	Max. Speed
1.0" (25 mm)	450	600	350	500	300	450	300	400						
1.5" (38 mm)	400	500	300	450	300	400	300	350						
2.0" (50 mm)	375	400	300	400	250	350	250	300						
2.5" (64 mm)	350	375	250	350	220	300	220	275						
3.0" (75 mm)	300	350	250	300	200*	250	200*	250						
4.0" (100 mm)	200	300	160	250	150*	225	150*	225	120	150	120	150	120	150
5.0" (125 mm)			160	200	150*	200*	150*	200*	100	150	100	150	100	150
6.0" (150 mm)							150*	180*	90	120	90	120	90	120
7.0" (175 mm)													90	120
8.0" (205 mm)													90	120

STANDARD



*Requires 1200 RPM Drive Motor